



Amelie Bed-Full Size

PRE-ASSEMBLY:

- Please read all instructions before assembling.
- Two or more people are recommended for assembly
- Save all packing materials until assembly is complete to avoid accidentally discarding smaller parts or hardware.

PARTS INCLUDED:

A – Headboard – 1pc

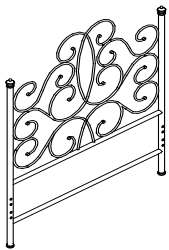

B – Footboard – 1pc

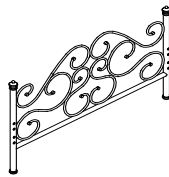

C– Side Rail– 2pcs

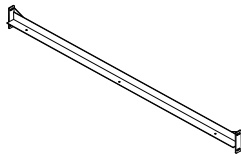

D– Metal Slats – 2pcs

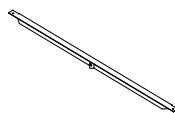

E– Metal Slats – 1pc

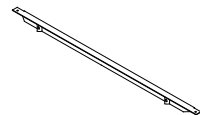

F- Short Support Leg - 4 pcs



G- Long Support Leg - 4 pcs



HARDWARE LIST

a – Bolt – 6pcs



b – Bolt – 12pcs

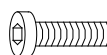

c – Spring Washer – 14pcs



d – Flat Washer (Iron Ø16*1mm) – 20pcs



e – Flat Washer (Rubber 1/4") – 8pcs



f – Nut – 6pcs



g – Allen Wrench – 1pc



h – Wrench – 1pc

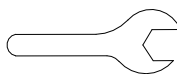

ASSEMBLY INSTRUCTIONS:

Step 1: Attach Side Rails (C) to Headboard (A) and Footboard (B) using Bolts (b), Spring Washers (c) and Flat Washers (d & e), tighten by hand at first, securely tighten with Allen Wrench (g), but do not over tighten. Please note there are two positions for Side Rails (C) and make sure both rails at same position, see **Figure 1**.

Figure 1

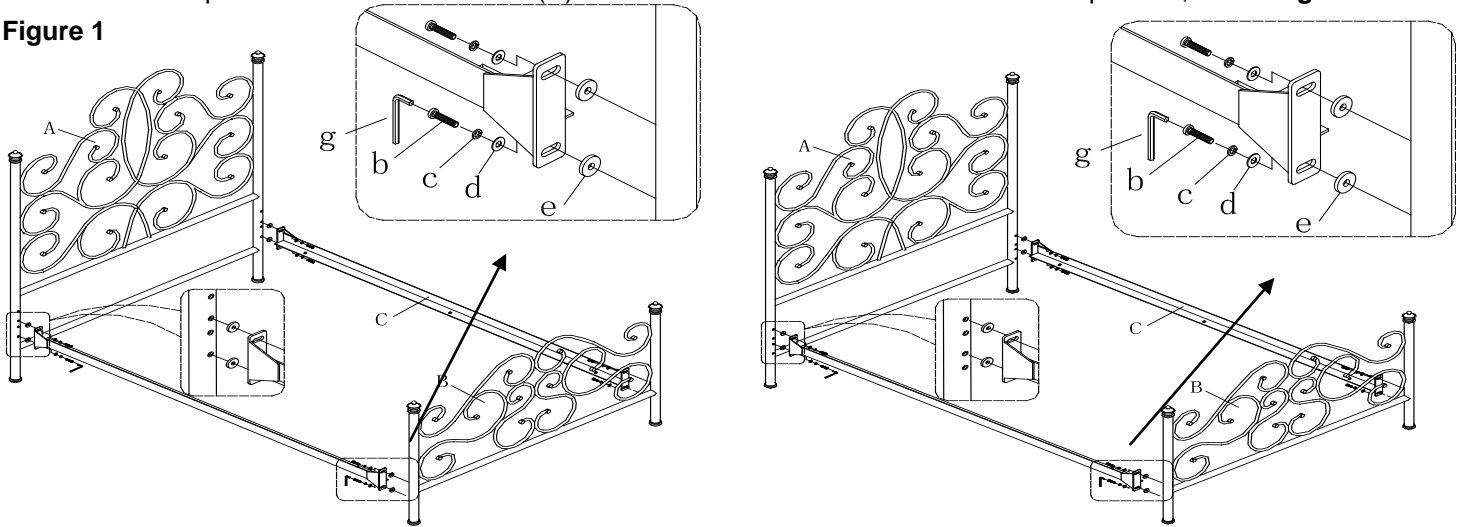

Step 2: Attach each Short Support Leg (F) or Long Support Leg (G) to Metal Slats (D & E), using Bolt (b), Flat Washer (d), tighten by hand at first, securely tighten with Allen Wrench (g), but do not over tighten. Please note Short Leg for low position and Long Leg for high position, see **Figure 2**.

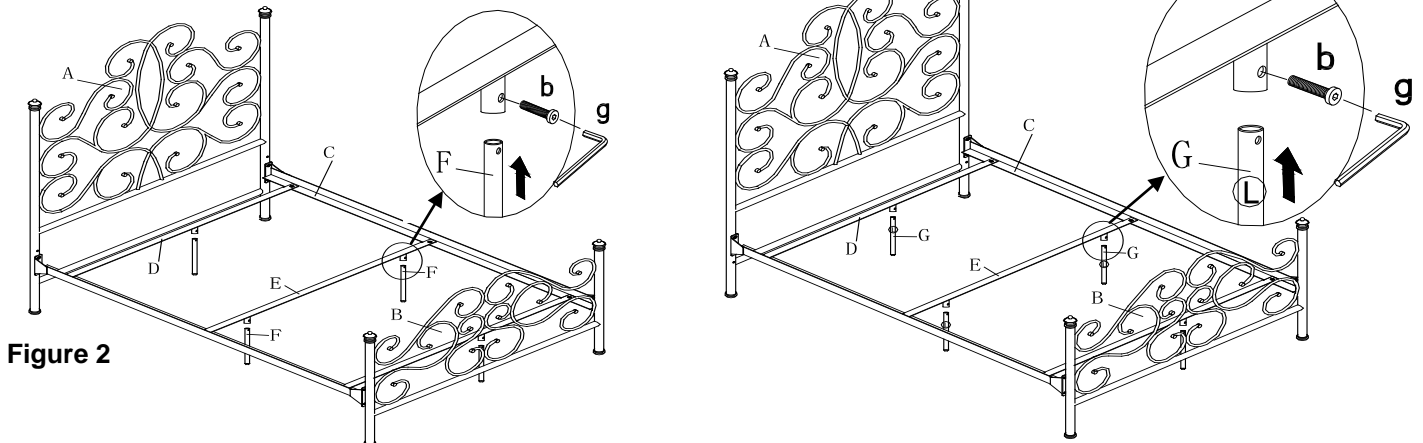
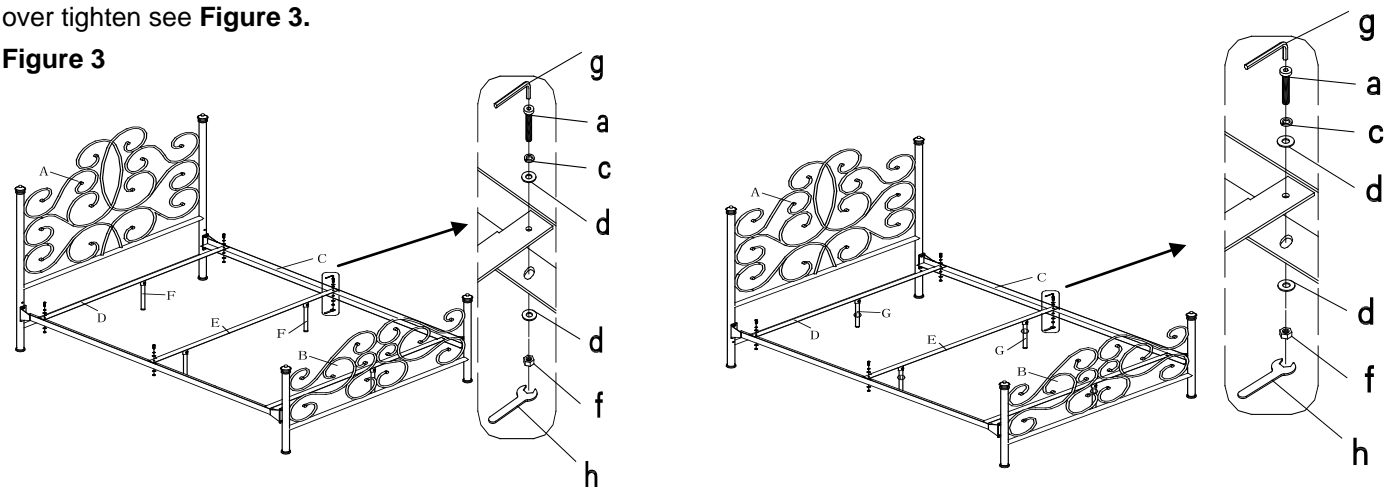

Figure 2

Step 3: Attach Metal Slats (D) with Support legs attached, to Side Rail (C) using Bolts (a), Spring Washers (c), Flat Washers (d) and Nuts (f), tighten by hand at first, securely tighten with Allen Wrench (g) and Wrench (h), but do not over tighten see **Figure 3**.

Figure 3



CARE INSTRUCTIONS:

- Wipe with a soft, dry cloth.
- To protect the finish, avoid the use of all chemicals and household cleaners.